



country properties  
village properties  
town homes  
barn conversions  
building plots

Isherwood Close  
Newton Aycliffe, DL5 5LG

**Offers in the region of £109,950**

**NICK & GORDON**  
**CARVER**  
RESIDENTIAL



Occupying a most convenient central location this THREE-STOREY family home offers spacious living accommodation throughout and features a GROUND FLOOR WC, first floor living room and kitchen/dining room and to the second floor three good size bedrooms and a shower room/WC. Externally there is a large enclosed garden to the rear with integral garage.





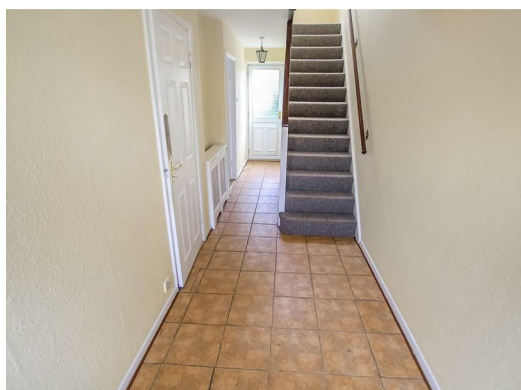

### **Agents Notes**

Tenure:- Freehold

Mains gas, (part central heating to radiators), electricity & drainage

Predominantly uPVC double glazing

Roof solar panels

Council Tax:- Band B

Local Authority:- Durham County Council

The property is offered for sale with NO ONWARD CHAIN



GROUND FLOOR  
44.9 sq.m. (484 sq.ft.) approx.

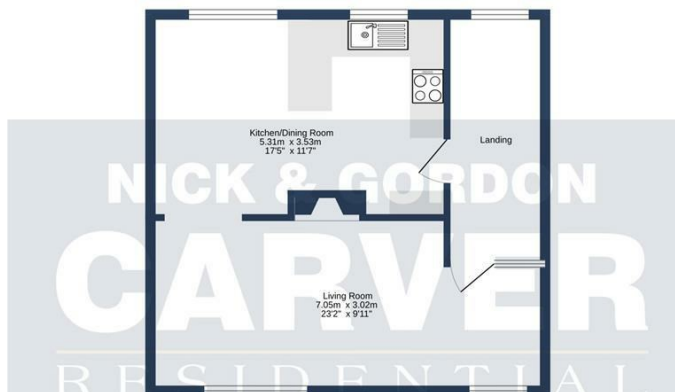

1ST FLOOR  
44.5 sq.m. (479 sq.ft.) approx.

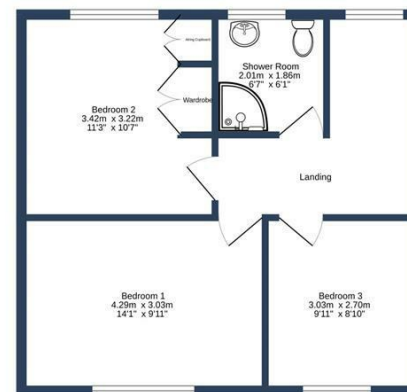

2ND FLOOR  
44.9 sq.m. (484 sq.ft.) approx.

ISHERWOOD CLOSE, NEWTON AYCLIFFE. DL5 5LG.

TOTAL FLOOR AREA : 134.3 sq.m. (1446 sq.ft.) approx.

Whilst every attempt has been made to ensure the accuracy of the floorplan contained here, measurements of doors, windows, rooms and any other items are approximate and no responsibility is taken for any error, omission or mis-statement. This plan is for illustrative purposes only and should be used as such by any prospective purchaser. The services, systems and appliances shown have not been tested and no guarantee as to their operability or efficiency can be given.

Made with Metropix ©2023

Energy Efficiency Rating		
	Current	Potential
Very energy efficient - lower running costs		
(92 plus) <b>A</b>		<b>85</b>
(81-91) <b>B</b>		
(69-80) <b>C</b>		
(55-68) <b>D</b>		
(39-54) <b>E</b>		
(21-38) <b>F</b>		<b>67</b>
(1-20) <b>G</b>		
Not energy efficient - higher running costs		
England & Wales		EU Directive 2002/91/EC

We can search 1,000s of mortgages for you

It could take just 15 minutes with one of our specialist advisers:  
Call: 01325 380088. Visit: Any of our Offices. Online: [www.mortgageadvicebureau.com/carver](http://www.mortgageadvicebureau.com/carver)



Your home may be repossessed if you do not keep up repayments on your mortgage. There will be a fee for mortgage advice. The actual amount you pay will depend upon your circumstances. The fee is up to 1% but a typical fee is 0.3% of the amount borrowed

MAB 6202



These particulars do not constitute any part of an offer or contract. None of the statements contained in these particulars are to be relied on as statements or representations of fact and any intending purchaser must satisfy himself by inspection or otherwise to the correctness of each of the statements contained in these particulars. The vendor does not make or give, and neither Nick & Gordon Carver Residential or Commercial, Nick & Gordon Carver, nor any person in their employment has any authority to make or give any representation or warranty whatever in relation to this property

naea  
propertymark  
PROTECTED

14 Duke Street, Darlington  
County Durham, DL3 7AA  
Tel: 01325 357807  
[sales@carvergroup.co.uk](mailto:sales@carvergroup.co.uk)

26 Market Place, Richmond  
North Yorkshire, DL10 4QG  
Tel: 01748 825317  
[richmond@carvergroup.co.uk](mailto:richmond@carvergroup.co.uk)

43 Dalton Way, Newton Aycliffe  
County Durham, DL5 4DJ  
Tel: 01325 320676  
[aycliffe@carvergroup.co.uk](mailto:aycliffe@carvergroup.co.uk)

219 High Street, Northallerton  
North Yorkshire, DL7 8LW  
Tel: 01609 777710  
[northallerton@carvergroup.co.uk](mailto:northallerton@carvergroup.co.uk)

[www.carvergroup.co.uk](http://www.carvergroup.co.uk)